



PAVILION TOWER

# PAVILION TOWER

Strategically located within Kuala Lumpur Golden Triangle

Next to Pavilion Kuala Lumpur, a world class shopping mall

Various sizes from 600 to 9,914 sq ft

Professional Property Management

Easily accessible to public transport, ie MRT and Monorail Bukit Bintang

Exclusive Marketing Agent



E (1) 0818

## BUILDING SPECIFICATIONS

Landlord Entity  
**MTrustee Berhad as Trustee  
of PAVILION REIT**

Location  
**Bukit Bintang**

Green Accreditation  
**Planned for LEED  
accreditation**

Typical Floor Plate  
**Approx. 9,914 sq ft**

No of Storey  
**20 storey**

Ceiling Height  
**2.70 m**

Floor Type  
**Under floor trunking**

Floor Loading  
**2.5kN//sqm**

Lift  
**5 passenger lift  
1 Bomba lift & Service lift**

Air-conditioning  
**Centralized air conditioning with  
UV Sterilizer system at AHU for all  
floors**

After hours charges  
**RM0.032 psf per hour**

Telecommunication  
**Fibre Optic backbone (Maxis, TM, Times)**

Lighting  
**Motion Sensor LED lighting installed  
at common area, ie staircases and  
washrooms**

Security  
**24 hours security  
CCTV  
Turnstile  
Visitor Management Systems**

Car Park  
**Allocation of 1000 sq ft : 1 bay**

Common Pantry  
**Available on all floors**

Electricity  
**60 amp per floor  
30 amp sub unit**

## ACCESS & CONNECTIVITY

Connected to Pavilion Kuala Lumpur Shopping Centre,  
Banyan Tree Kuala Lumpur & Pavilion Hotel

Easily accessible through Jalan Bukit Bintang,  
Jalan Raja Chulan, Jalan Sultan Ismail & Jalan Tun Razak

Short walk to Bukit Bintang MRT & Monorail Station

## LOCATION



# FLOOR PLAN

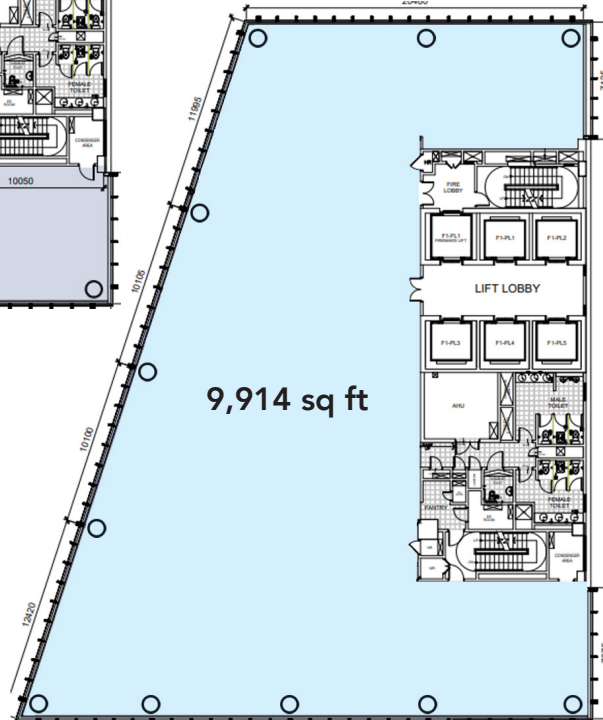
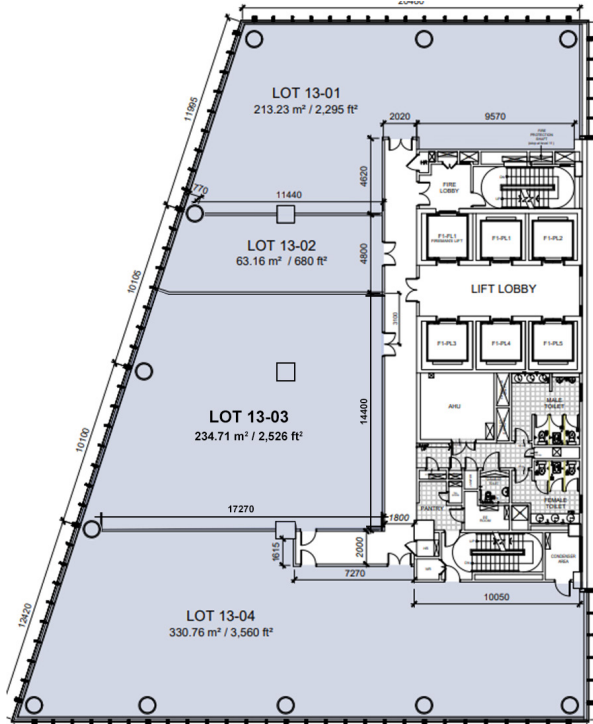

LIFT LOBBY



TYPICAL FLOOR

For enquiries please call :

**Yasmine Zamirdin** (PEA 1964)

yasmine.zamirdin@ntl.my

**+6012 224 5107**

**Carrey Foong** (PV2375)

carrey.foong@ntl.my

**+6011 1072 2330**

**+603 2161 7228**

www.ntl.my

Exclusive Marketing Agent



E (1) 0818

@ Copyright 2024 NTL All rights reserved.

This flyer, the layout and information herein are intended to provide a general introduction of the proposed development and is subject to change without notice and shall not in any circumstances whatsoever form or be part of any agreement, offer or contract nor be construed, whether implied or otherwise, as a statement, representation or warranty, whether in part or as a whole, as to the accuracy of the same. The developers and/or Nawawi Tie Leung Real Estate Consultants Sdn Bhd shall not be held responsible and/or liable howsoever for any inaccuracies of the information herein nor be obligated to update or inform the recipient of this brochure and/or layout of any changes or misinformation on the same. All prospective tenants are advised to rely on their own assessment/evaluation and make their own enquiries and verification as to the accuracy of the information in this brochure and layout and on all pertinent matters.

Nawawi Tie Leung Real Estate Consultants Sdn Bhd (525823-T)

Suite 34.01, Level 34, Menara Citibank, 165 Jalan Ampang, 50450 Kuala Lumpur, Malaysia.